

nylex

PRODUCT MANUAL

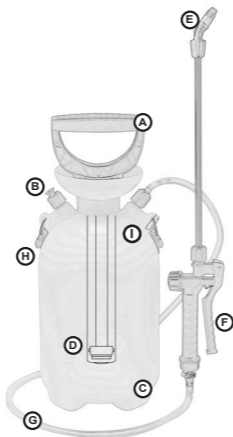

**Heavy Duty Shoulder Sprayer
5L & 8L**



- A. Pump Handle with lance holder
- B. Safety Valve
- C. Spray Bottle
- D. Pump Assembly
- E. Stainless steel lance with two nozzle options
(fan and cone spray patterns)
- F. Trigger Assembly
- G. Hose
- H. Shoulder strap
- I. Liquid ID tag



Liquid Identification Tag

The Nylex shoulder sprayer is supplied with a liquid identification tag which allows you to quickly and easily identify what substance is inside your sprayer.

The liquid identification tag comes with pre-determined inserts or you can personalise your own inserts by writing with permanent marker onto the blank inserts supplied.

The inserts are fitted into the tag by simply opening the tag, positioning the insert so that the text is facing upwards and clicking the lid of the tag back into position.

Safety Instructions

Always wear protective clothing including safety glasses and gloves when using this sprayer.

This sprayer is designed for domestic use only and is to be used with liquids that are suitable for use with Viton® seals. Follow the liquid manufacturers safety instructions prior to use.

Liquids used with sprayers can be dangerous; if swallowing or skin contact occurs, always refer to the safety instructions of the liquid used or contact the poisons information centre or a doctor immediately.

Avoid spraying in windy conditions.

Store out of direct sunlight and away from children.

Always release pressure before filling, cleaning or storing.

Lance Assembly

Instructions:



Image 1



Image 2

- 1 Ensure both ends of the stainless steel lance have components fitted in the correct order as per the images shown.
- 2 Attach the trigger assembly to the end of the stainless steel lance with the large seal (Image 1).
- 3 Attach the nozzle to the other end of the stainless steel lance (Image 2).
- 4 Ensure all fittings are tightened prior to spraying.

Operating Instructions

Preparation:



1 Before filling, release any pressure built up within the bottle by lifting the safety valve.



2 Unscrew and remove the pump by turning the handle in an anti-clockwise direction.



3 Fill the bottle with liquid to the desired level. Do not exceed the maximum capacity level marked on the bottle.



4 Screw the pump handle back into position by turning the handle in a clockwise direction. Ensure all fittings are tightened before proceeding.

Operating Instructions

Spraying:

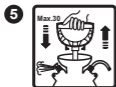

Pressurise the bottle by pumping the lever up to 30 times. Do not over pressurise.



Air will escape through the safety valve if the pressure is too high.

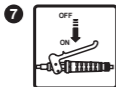

Spray the desired area by holding down the trigger on the nozzle. The trigger can be locked for continual spraying.



Choose the type of nozzle according to your spraying application.

Cleaning:



Ensure that pressure is released and that all sprayer components are rinsed thoroughly with a suitable cleaning agent (refer to liquid manufacturer). This can be achieved by filling the bottle with the cleaning agent, pressurising and then emptying via the nozzle.

Ensure liquids are disposed of safely and in accordance with the legislation and liquid manufacturers advice.

Guarantee

3 YEAR GUARANTEE*

*Cyclone Tools guarantees that this product will be free from defects in workmanship and materials for the period of 3 years from the date of purchase. If a defect in material or workmanship becomes evident during that period Cyclone Tools will, at its option, either:

- replace the product; or
- refund to the customer the purchase price paid by the customer for the product.

In the event of such a defect, the product should be returned to the place of purchase, together with proof of purchase and prior to the date that is 3 months from the end of the guarantee period, for replacement or refund. Any handling and transportation (and other expenses incurred in claiming under this guarantee) are not covered by this guarantee and will not be borne by Cyclone Tools.

The obligation of Cyclone Tools under this guarantee is limited to the circumstances set out above and is subject to:

- the product not having been altered, tampered with or otherwise dealt with by any person in a manner other than as intended in respect of the relevant product; and
 - the product not having been used or applied in a manner that is contrary to customary usage or application for the relevant product or contrary to any stated instructions or specification of Cyclone Tools.
- In addition to other rights and remedies that may be available under law, our goods come with guarantees that cannot be excluded under Australian Consumer Law (for consumers in Australia) and the Consumer Guarantees Act (for consumers in NZ). If you are a consumer in Australia, you are entitled to a replacement or refund for a major failure and compensation for any other reasonably foreseeable loss or damage. You are also entitled to have the goods repaired or replaced if the goods fail to be of acceptable quality and the failure does not amount to a major failure. If you are a consumer in New Zealand, we will comply with our obligations to you under the Consumer Guarantees Act.

Cyclone Tools Pty Ltd, ABN 89 169 427 061
317 Abbots Road, Dandenong South, Victoria 3175, Australia
Ph: (613) 8791 9300

Viton® is a registered trademark of DuPont Performance Elastomers.

The logo for nylex features the word "nylex" in a bold, dark blue, lowercase sans-serif font. The letter "x" is stylized, with its right vertical stroke and the bottom-right diagonal stroke rendered in a bright blue color, while the top-right diagonal stroke remains dark blue.

Cyclone Tools Pty Ltd
ABN: 63 004 235 063
317 Abbots Road, Dandenong South,
VIC, 3175, Australia
Australia Free Call: 1800 335 019
Website: www.nylexwatering.com
www.nylexwatering.co.nz